

modpod

Product Description

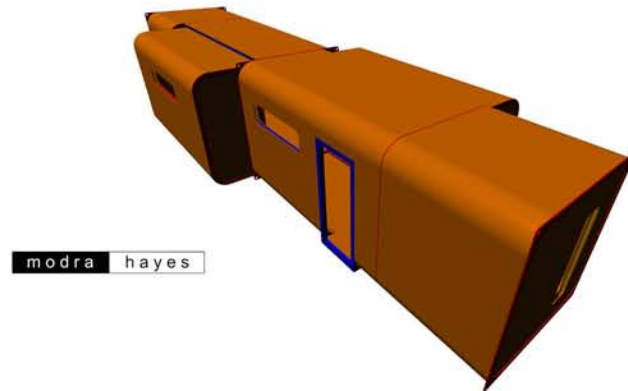

The modpod® is a demountable accommodation system that has been designed for the mining and defence industries. This housing offers a superior alternative to that currently available. modpod® are moulded out of an aero military grade composite that offers strength and durability.

The unit is not only strong but is also simply constructed and easily transported to remote areas. The conditions of these remote areas have been considered in the design, the modpod® offering exceptional thermal and acoustic insulation.

Strong and long lasting, simply constructed and transported, aesthetically pleasing and comfortable to live in are all elements that combine to create an exceptional product.

Materials Used / Method

The modpod® has been developed to satisfy the needs of the current demountable housing market. The simplicity of its design contrasts the sophistication of the materials used in the manufacture of the house. The frame of the house consists of a laser cut box steel structure. The panels are made from a honeycomb composite material rarely before used in Australian production. The panels are vacuum formed to a pressure of one atmosphere, the result being that the panels are both tough, six times stronger than steel by weight, and at the same time extremely light. All modpod® are made using fire retardant resins.

modpod

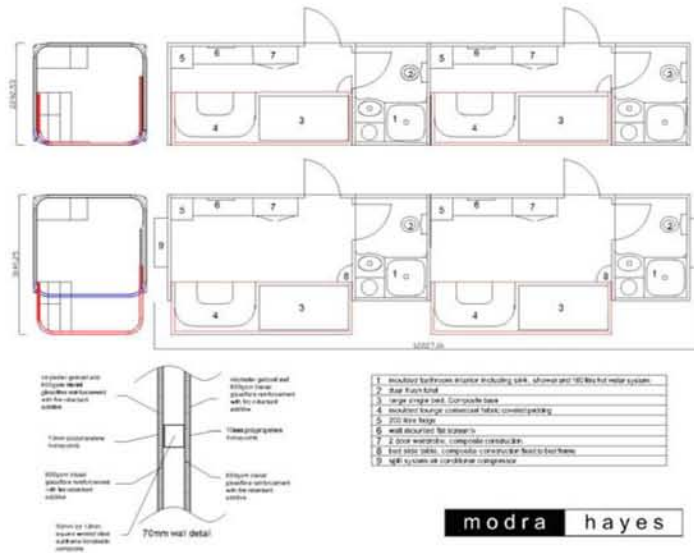

The airspaces within the honeycomb cells and the airspace within the wall cavity provide thermal insulation. This reduces the electricity used for air-conditioning in hot climates. Likewise, the varying density of the materials through which sound waves must pass breaks the waves up in a similar way to double-glazing.

modpod

Exterior

Slides out for extra internal
Space

Transportation size is the same
as a 20ft shipping container

Twist lock system for
transport and also for locking
it into place on the ground

Crane lifting points
although can also be
lifted by a small forklift



modpod

Setting the new standard in transportable housing

modpod

Floorplan

Expanded

Transport size

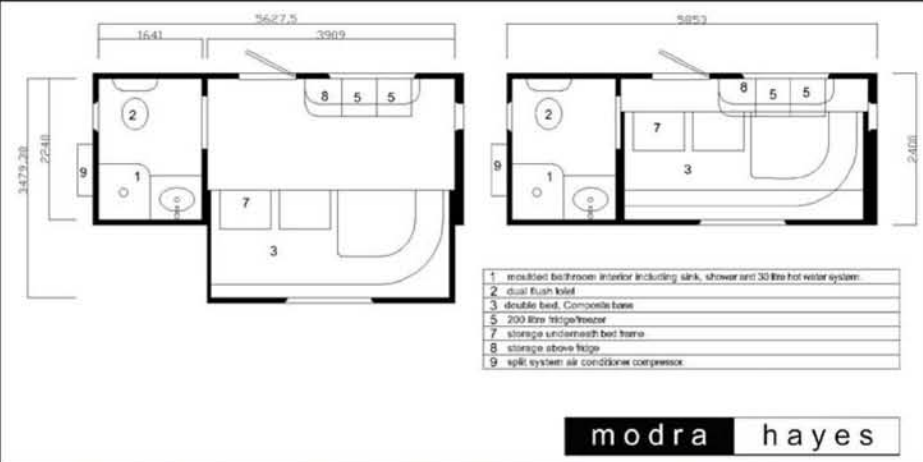

modra hayes

The units can be bolted together on site to provide a larger space
The configuration can be changed to suit individual needs

modpod

Setting the new standard in transportable housing

modpod

Living



Queensize bed
Bar fridge
Microwave
Airconditioner

All upholstery and carpet
are marine grade
-Easy to remove & clean

Some of the many options
available include:
Stove
Wardrobe
Outdoor lockable storage
Canopy outside
Curtains

modpod

Setting the new standard in transportable housing

modpod

Bathroom



Shower



The exterior reverse cycle airconditioner unit is fitted in here



Instant hot water service is fitted under the wash basin in the bathroom

modpod

Setting the new standard in transportable housing

modpod

The modpod© housing units have been designed by ModraHayes using technologies developed by Lotus Racing for Formula One Cars. The company employs matrix and sandwich construction that embraces weight reduction and advantages in strength. Honeycomb composite is a minimum of six times the strength of steel by weight.

The modpod© can be specifically engineered to suit the clients purposes; such as bullet proofing for the defence force, and cyclone proofing for the mining industry in Western Australia

Transport

The modpod© system is designed within the standard dimensions of a 40ft shipping container and is therefore easily transported to remote sites via existing shipping container logistics. The unit is then deployed by pulling out the expansion units, easily creating a comfortable living area. The modpod© uses a container shipping twist lock system for anchoring to sites and transport.

The relative lightness of this material contributes to simplify logistics and handling.

Interior Layout

The often-harsh climatic conditions in these remote areas have also been considered when selecting the material used for the panelling and interior of the modpod©.

The exceptional thermal and acoustic insulation that the material offers has also been paramount.

The honeycomb composite and polished fibreglass insides mean that an array of interior design configurations is available – that are again aesthetically pleasing and durable. The furniture and interior fittings are literally moulded into the unit offsite, to provide clients with an instant interior that is both stylish and modern. This also improves durability.

The moulded interior makes cleaning easy. The carpets are marine grade, and put in place with valcro – simply remove them for cleaning. The interior can be hosed out.

modpod

Competative advantage of the Modpod©

The unit folds into the dimensions of a shipping container which helps to reduce shipping costs. The modpod© can be transported via road, rail or sea requiring no special modifications. Incorporated into these design logistics are standard twist locks and expanding and contracting nature of the product.

The material does not require paint, a factor that enhances the longevity of the product and its comparable aesthetics over time against its competitors.

Its impact resistance limits maintenance over time.

All the amenities are built into the modpod© when it arrives. The hot water service, air conditioner, plumbing and electrical wiring are all complete. Once the unit arrives on site plug the water, electricity and sewage in, and the modpod© is ready to use.

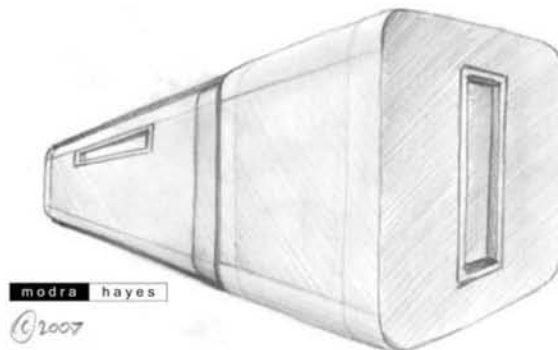

modpod

ModraHayes experience with the product in commercial application of the technologies that will be employed by the modpod®, allow the company to surmise that not only will the product offer the aforementioned advantages but will outlast any existing product currently available.

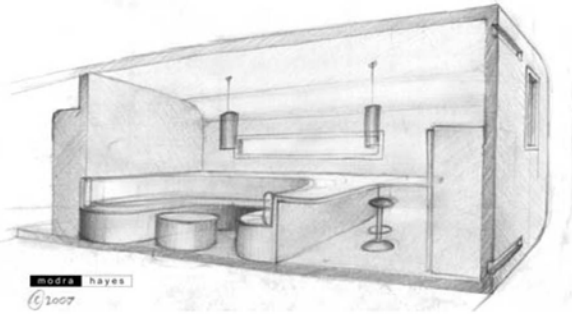

modpod

